



## Vertical Zip Screen

### Installation Guide

# INDEX

---

## Pre-Installation Preparations

Sayfa

1) Preparation of the Installation Area .....	3
2) Arrangement of the Work Area .....	3
3) Material and Order Check .....	3
4) Compliance and Competence .....	3
5) Installation and Fastening Rules .....	3
6) Required Equipment .....	3
7) Working at Height and Fall Protection .....	3
8) Electrical and Environmental Conditions .....	3

## Installation Steps

1) Removing Side Channel Screws and Covers .....	4
2) Installation of the Side Channel .....	5
3) Placing the Cassette onto the Side Channels .....	5
4) Fixing the Cassette .....	6
5) Inner Bar Installation .....	6
6) Setting the Motor's Upper and Lower Limits .....	7
7) Fixing and Locking the Side Channel Cover .....	7
8) Closing the Cassette Cover and Completing the Installation .....	8

## Post-Installation Check

1) Technical Checklist .....	9
2) Notes .....	9

# Pre-Installation Preparations

## 1) Preparation of the Installation Area

**Measurement:** The width and height of the window opening should be measured to ensure compatibility with the zip system.

**Perpendicularity and Parallelism:** Ensure that the edges of the opening are perpendicular and parallel to each other.

**Top Beam Check:** The top beam should be smooth, straight, and horizontal.

**Removal of Obstacles:** There should be no protruding elements inside the room. The top beam, side surfaces, and floor imperfections should be cleaned.

**Surface Smoothness:** The areas where the box and guide rails will be mounted should be smooth and flawless.

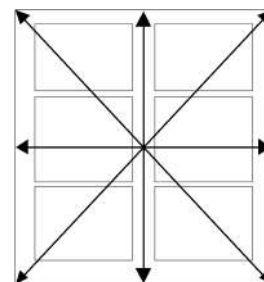

## 2) Arrangement of the Work Area

The installation area is cleaned and the necessary space is provided. Any items, obstacles, or construction debris that could hinder the work are removed. A tidy area contributes to a faster and safer installation process. In addition, a specific order is established in the work area to prevent equipment from being scattered during installation.

## 3) Material and Order Check

Before assembly, the product and all accompanying accessories are checked to ensure they are complete, undamaged, and consistent with the order. Ensuring that all parts are complete and undamaged prevents time loss and errors during the assembly process. All components are placed in an orderly manner in the assembly area and made easily accessible.

## 4) Compliance and Competence

Installation should only be performed by individuals with the necessary knowledge and experience. Compliance with the manufacturer's instructions is mandatory, and only qualified personnel should be involved in the installation process. This ensures both product safety and long-term reliability.

## 5) Installation and Fastening Rules

The fasteners to be used during installation must be selected according to the structural properties of the surface to be applied. Before starting work, the load-bearing capacity and stability of the building must be checked. In weak or insufficiently rigid structures, the correct functioning of the system cannot be guaranteed, and the product does not provide additional strength to the building. The suitability of the fastening elements to be used must be checked by the installation team and, if necessary, adapted to the application surface. The manufacturer is not responsible for problems arising from the use of unsuitable fastening elements or structural inadequacies.

## 6) Required Equipment

The correct equipment must be available to ensure the smooth progress of the installation process. The following equipment is prepared for installation:

- Measurements are taken with a tape measure.
- The installation points are marked with a marking pen.
- A ladder or scaffold is used for safe working.
- A screwdriver set (star, flat, Torx bits) and a spirit level are kept ready for different connections and correct alignment.
- A motor test cable is used to check electrical connections.
- Dowels and screws are selected in appropriate sizes for fastening.
- An electric drill and suitable bits facilitate installation.

## 7) Working at Height and Fall Protection

A sturdy platform or scaffold is used for installations at high elevations. Safety harnesses and fall arrest equipment are used without exception for worker safety. During installation, do not lean on the curtain or place excessive load on the connection elements. These precautions prevent accidents and material damage.

## 8) Electrical and Environmental Conditions

Suitable outlets and wiring for electrical connections are checked in advance. When necessary, support is obtained from qualified electricians. Environmental conditions are also taken into account; if there is wind, rain, or adverse weather conditions, installation is postponed. This ensures both worker safety and the trouble-free installation of the product.

# Installation Steps

## 1) Removing Side Channel Screws and Covers

To ensure proper installation, the connecting screws on the side channel, the side channel cover, the bottom cover, and the inner strip are removed. First, the connecting screws on the side channel are loosened and removed using an Allen wrench. This step is necessary to ensure the channel is positioned correctly during installation. Then, the side channel cover, bottom cover, and inner strip are carefully removed. This process ensures that the fabric zipper line is positioned smoothly.

### Points to note at this stage:

- The side channel must be supported while removing the screws to prevent it from falling or slipping.
- The Allen screws, side channel cover, bottom cover, and inner strip that are removed must be kept for reuse during reassembly.
- Care should be taken to ensure that the foam pieces on the inner rail are not lost or damaged.
- No excessive force should be applied to the channel during removal.



Watch the  
installation stage

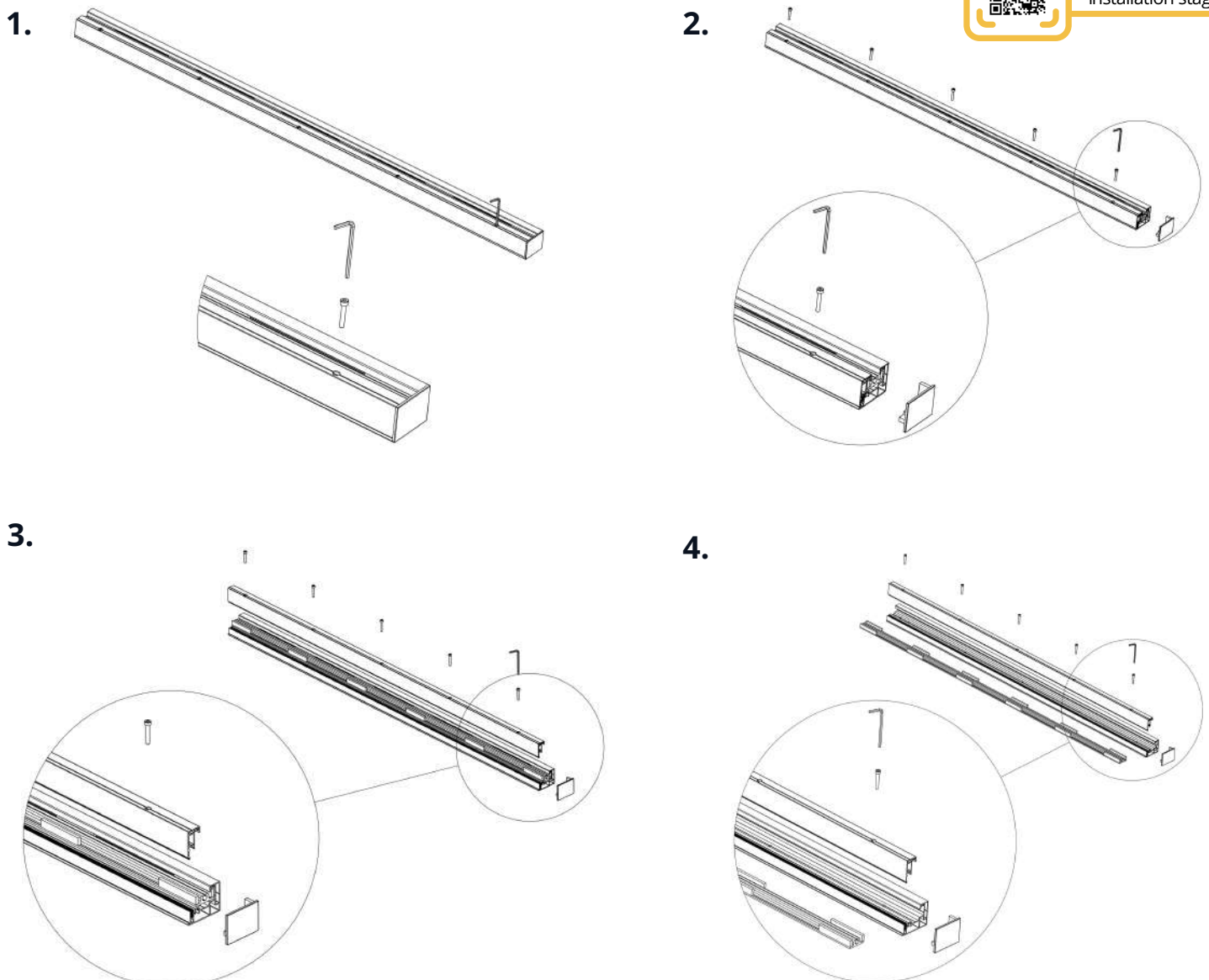

## 2) Installation of the Side Channel

The side channel profile is the supporting and guiding element of the curtain system. After positioning it perpendicular and parallel to the mounting surface, it is recommended to check it with a spirit level. It is secured to the wall using appropriate screws and dowels through the pre-drilled mounting holes on the channel.

### Points to note at this stage:

- Aligning the side channel with the box on the same axis,
- Tightening the screws gradually,
- Securing the channel in a vertical position during installation.

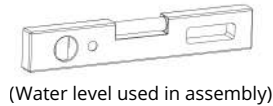

(Water level used in assembly)

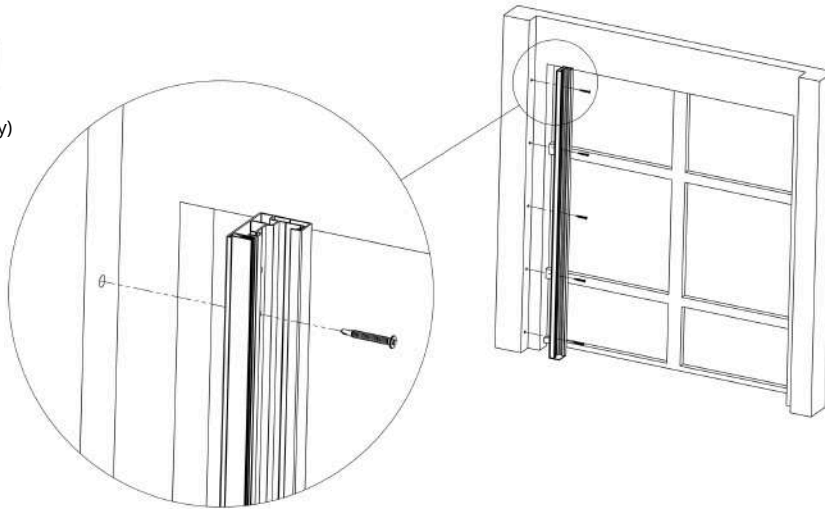

Watch the  
installation stage

## 3) Placing the Case onto the Side Channels

After the side channels are installed, the curtain box is placed on the side channels. The downward arrow in the image indicates the installation direction of the box. The box is aligned with the top points of the side channels and slid downwards into place.

### Points to note at this stage:

- The box must be slid so that it is level with the side channels.
- Excessive force should not be applied to the box during installation.
- When fully seated, there should be no gap between the box and the side channels.

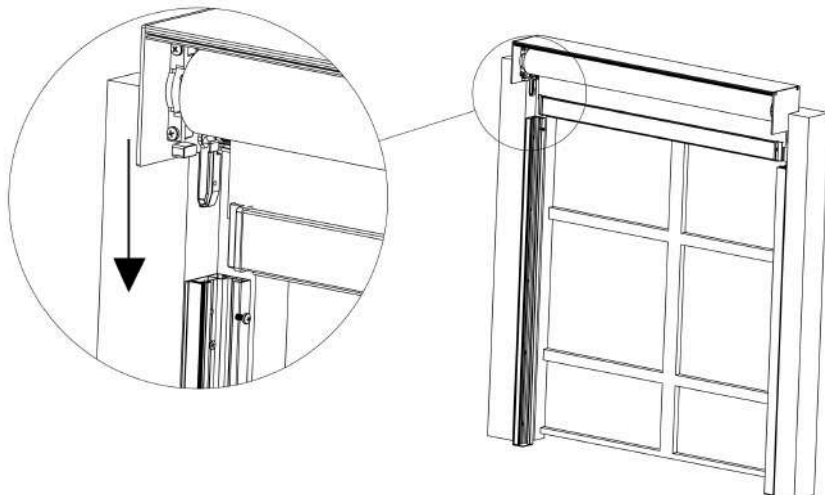



#### 4) Fixing the Case

After the casing is seated, the upper part of the side channels is secured with additional screws. This prevents the channel from opening upward and flexing after installation.

##### Points to note at this stage:

- The screw must be inserted through the pre-drilled hole on the side channel profile and secured to the mounting surface.
- The upper part of the channel must be aligned perfectly with the box.
- Do not overtighten; the screw must be secured in such a way that it does not distort the shape of the channel.

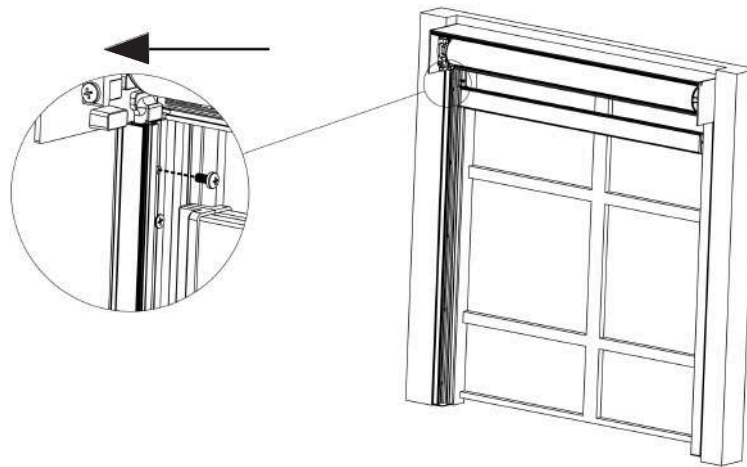

#### 5) Inner Bar Installation

The zip section of the bottom bar located under the casing is inserted into the head section of the inner strip. The inner strip is then seated into the inner cavity of the side channel and secured to the channel body. The foam pieces on the strip fill the gaps, preventing swaying and vibration. This securing eliminates the risk of the fabric slipping or pinching along the zip line.

##### Points to note at this stage:

- Check that the zipper is fully seated on the inner strip.
- The foam pieces must be placed completely; otherwise, the strip may become loose.
- The strip should not be forced into place but should be slid smoothly into position.

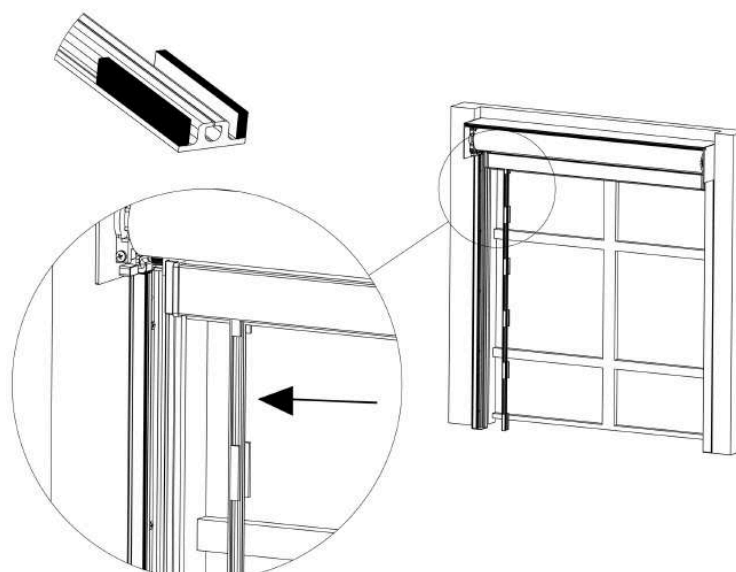

Watch the  
installation stage

## 6) Setting the Motor's Upper and Lower Limits

After the mechanical installation is completed (before closing the cassette cover), it should be noted that the limit settings are not pre-adjusted at the factory. The screen's travel limits must be set before operation.

Set the limit positions according to the project, brand, and model.

### Points to consider during this stage:

- The screen must not be operated before the limit settings are adjusted.
- During adjustment, always follow the motor manufacturer's instructions.
- Incorrect limit settings may cause the motor to overload and may damage the fabric.



Watch the installation stage

#### 1) Automation Integration

##### Lower Limit Setting

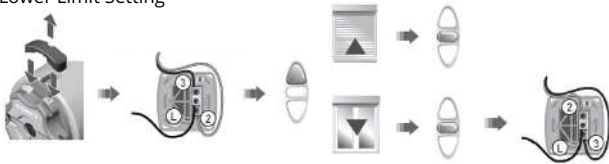

##### Upper Limit Setting



#### 2) Remote Control Integration

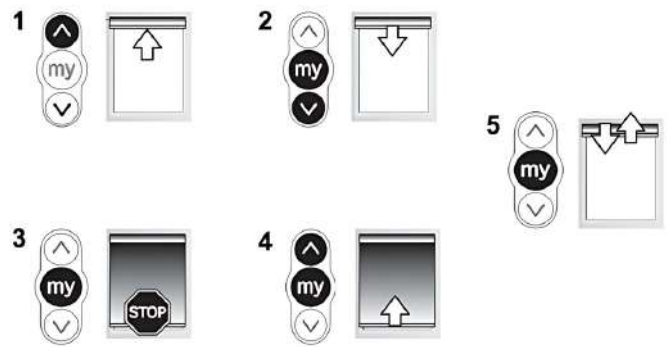

## 7) Fixing and Locking the Side Channel Cover

The side channel cover, once positioned, is first secured to the channel body using screws through the mounting holes on the front surface. This prevents the cover from shaking or shifting over time. Afterward, the cover is rotated toward the inner mechanism, properly seated, and fully locked by tightening the Allen screws.

Points to consider at this stage:

- The cover must fit evenly on both sides with no gaps.
- Screws should be tightened enough to secure the cover, but excessive force should be avoided to prevent damage to the channel profile.
- After tightening the Allen screws, ensure that the cover is fully seated on the channel body.



Watch the installation stage

1.

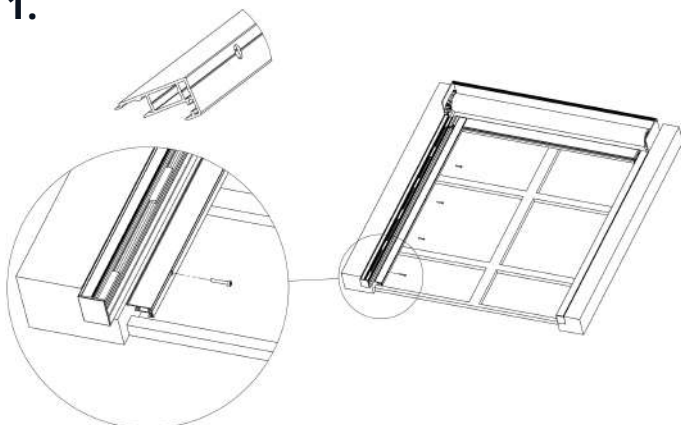

2.

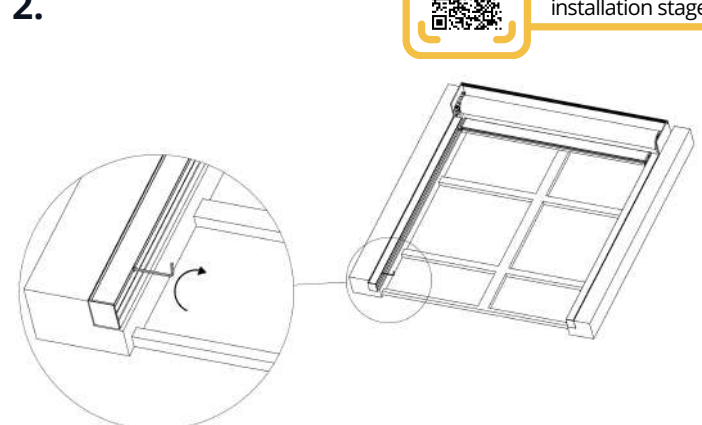

## 8) Closing the Cassette Cover and Completing the Installation

After all mechanical connections are completed, the cassette (top) cover is closed. The cover is aligned with the body, pressed into the locking tabs/slots, and, if necessary, secured by tightening the mounting screws/Allen screws.

Points to consider at this stage:

- There should be no gaps along the entire cover; it must sit evenly on both sides.
- Cables and moving parts must not be pinched between the cover and the body.
- Screws should be tightened enough to secure the cover, but excessive force should be avoided to prevent damage to the profile.
- After closing, there should be no friction during the open-close test of the screen.

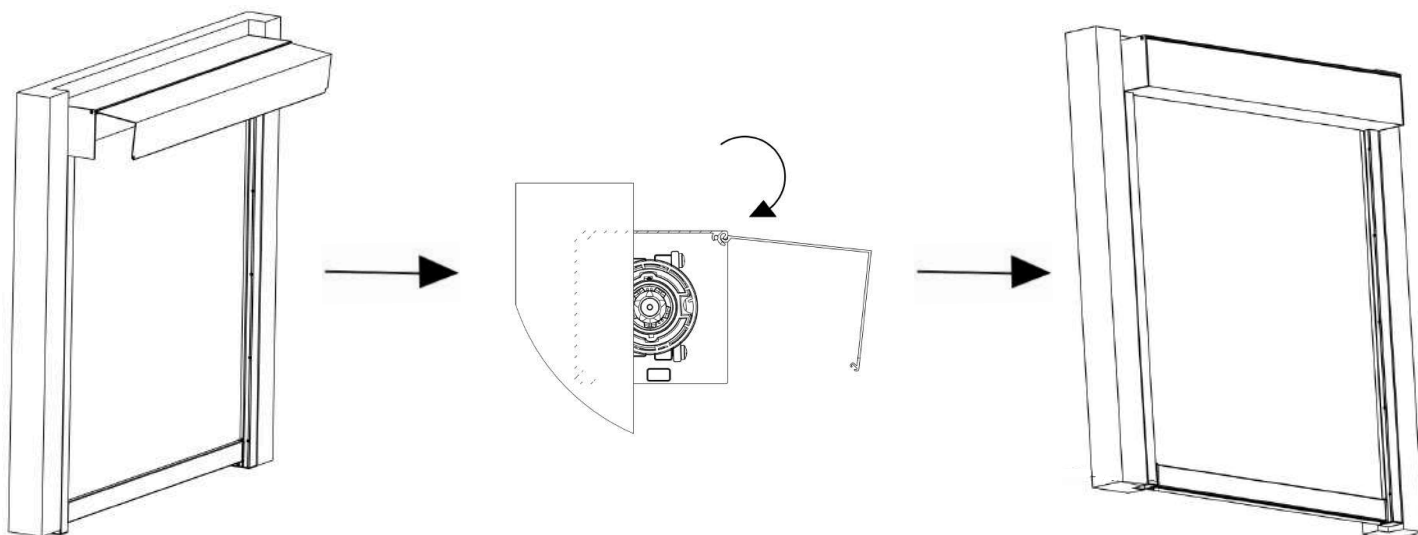

- Closing the case cover completes the system installation, and the zip screen is ready for use.





## Post-Installation Check

### 1) Technical Checklist

After installation is completed, check the following steps:

**Casse Installation:** Is the cassette securely and properly mounted to the surface?

☐

**Side Channels:** Are the side channels parallel, vertical, and their screws tightened?

☐

**Fasteners:** Are all Allen screws and mounting screws fully secured?

☐

**Vertical and Horizontal Alignment:** Is the system leveled correctly with no misalignment or shifting?

☐

**Fabric Tension:** Does the fabric move smoothly and tightly within the side channels?

☐

**Function Test:** Does the system perform open/close movements without any issues?

☐

**Final Check:** Have all connections been inspected and confirmed, ensuring the system is ready for use?

☐

(The boxes above are provided to indicate that each step has been completed during assembly.)

### 2) Notes

---

---

---

---

---

---

---

---

---

---



# Gunpay

SHADING SYSTEMS

Address: Ferhatpasa Mah. Atatürk Boulevard,  
G-48 Sk. No:9, Atasehir / ISTANBUL, TURKEY  
Phone: +90 (216) 471 78 68  
Fax: +90 (216) 471 78 65  
Mobile: +90 (532) 483 09 20  
E-mail: info@gunpay.com.tr  
Web: www.prozipscreen.com

You can scan the QR code with your phone for  
quick access to our Pro Zip Screen website.



All texts in this catalog have been created to reflect Günpay Shading Systems' products and services. The content has not been copied from any source; it has been specially developed to meet the company's needs and structured in accordance with industry-specific terminology.

All descriptions have been prepared with a user-friendly approach, prioritizing technical accuracy. Both the integrity of the content and the language used are the property of the Günpay brand and may not be quoted or used in other projects without permission.

© 2025 Günpay Shading Systems – All rights reserved.

